

Troubleshooting Notes:

Problem	Cause	Solution
Incorrect count on console on installation.	Rapid-Fire Pulser switch is in the incorrect position for the application.	Check for correct position of switch: 100:1 Mechanical Computers (Gallons or Liters) Non-Computers (Gallons or Liters) 10:1 Non-Computers (Gallons or Liters)
Sensor is binding and/or chattering. Erratic Count. Missing Pulses.	Bent-tie bar — Does not allow proper tooth engagement between sensor gear and the gear on side of wheel. Depending on how it is bent will cause: Too much pressure and binding. Too little — gears will not engage and slip.	Remove tie-bar and straighten/flatten. -or- Replace tie-bar with a tie-bar from another computer. -or- Call PMP for a replacement tie-bar. 800-243-6628
Pulser won't count on installation.	Improper wiring connections. Defective pulser. Pulser is not compatible with console model.	Recheck wiring connections. Call PMP for technical assistance. 800-243-6628 Call PMP for technical assistance. 800-243-6628

Specifications:

Input Voltage Range	Electronic Console Pulse Circuit Range	Operating Temperature	Operating Speed (Computer Wheel)
70 VAC to 130 VAC	5 to 400 VAC/DC	-40°F to +160°F -40°C to +71°C	200 RPM maximum* 20,000 pulses per minute

*Rapid-Fire Pulser tested to a speed of 600 RPM

Wiring Connections:

Rapid-Fire Pulser #48504	Black Wire	White Wire	Blue Wire	Blue Wire
115 VAC Pulser	115 VAC Hot	Neutral	Pulser Circuit	Pulser Circuit
These wires are interchangeable.				

Switchable PMP Rapid-Fire™ Pulser

Lower Wheel Bank Installation Instructions

PMP #48504

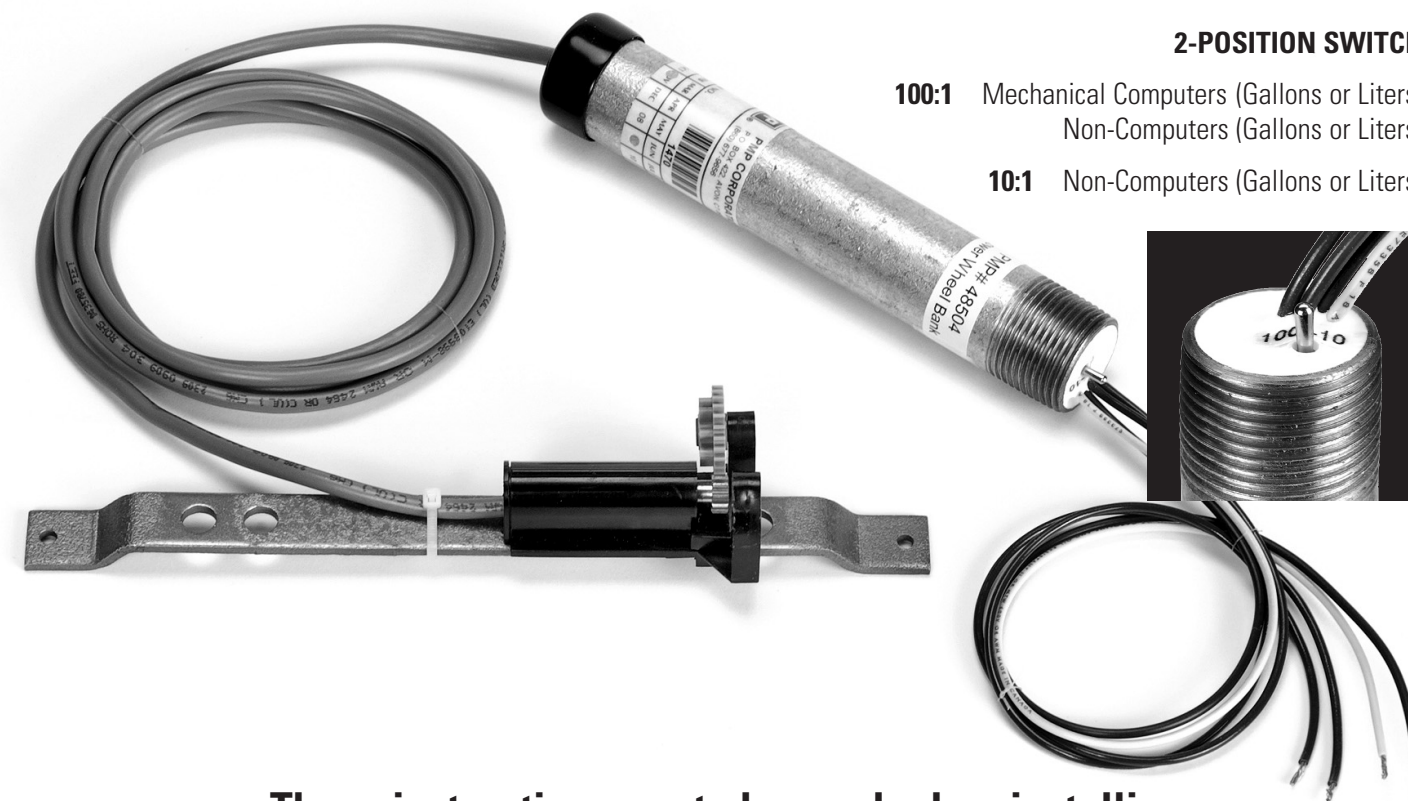

2-POSITION SWITCH

- 100:1** Mechanical Computers (Gallons or Liters)
Non-Computers (Gallons or Liters)
- 10:1** Non-Computers (Gallons or Liters)

These instructions are to be used when installing a Switchable PMP Rapid-Fire Pulser on the lower wheel bank.

INTRODUCTION

The Rapid-Fire Pulser is an intrinsically safe, easy to install pulsing device for use with most mechanical computers or non-computers.

The intrinsically safe feature of the Rapid-Fire Pulser eliminates the need to install conduit or M.I. cable and therefore significantly reduces installation time and cost.

The Rapid-Fire Pulser can interface with any electronic console pulse circuit from 5 to 400 VAC/DC, with a current requirement not exceeding 100 mA.

There is no need to remove the computer or non-computer from the dispenser.

WARNING Before installing the Switchable Rapid-Fire Pulser, TURN OFF all circuit breakers that control power to the dispenser to be serviced. Take adequate precautions to prevent circuit breakers from being turned on until all work has been completed. More than one circuit breaker may have to be TURNED OFF to completely disconnect the power. Failure to comply with this warning could result in serious personal injury, equipment damage, property damage and even death.

The Switchable PMP Rapid-Fire Pulser consists of two components: The barrier, which is connected to the dispenser's junction box, and the sensor that mounts on the non-computer. Incorporated in the PMP 48504 Switchable Rapid-Fire Pulser barrier is a 2-position switch.

Contents

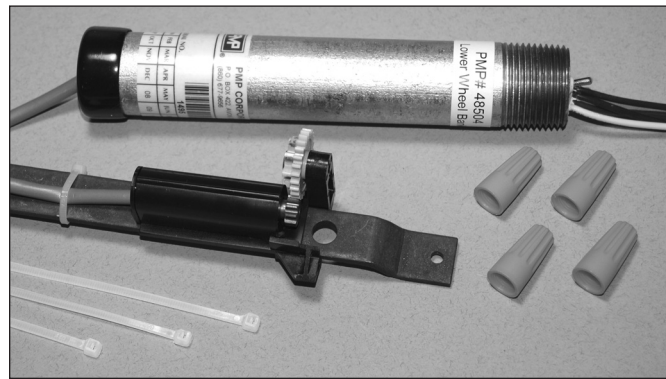

- 1 – Barrier hardwired to Sensor
- 1 – Tie-bar with Sensor pre-attached
- 3 – Cable ties
- 4 – Wire nuts
- 1 – Installation instructions

Tools needed



- 1 – Flat blade screwdriver
- 1 – Torx T20 screwdriver
- 1 – Channel Lock pliers
- 1 – Wire-cutters to trim tie wraps

The PMP 48504 Switchable Rapid-Fire pulser has a 2-position toggle switch located at the threaded end of barrier. There is a small label next to the switch which indicates the switch position. Changing the switch position will give you settings of 100 or 10 pulses per revolution of the register wheel. The PMP Rapid-Fire pulser is shipped with the switch in the 10:1 position.

Rapid-Fire Barrier Installation (Refer to Figure A)

1. Turn off all power to the dispenser.
2. Remove dispenser junction box cover.
3. Remove a plug from a 3/4" NPT location that will allow clearance for the 6" length of the barrier.
4. Set the switch in the correct position for the application:
 - 100:1** Mechanical Computers (Gallons or Liters)
Non-Computers (Gallons or Liters)
 - 10:1** Non-Computers (Gallons or Liters)
5. Install the barrier by screwing it into a 3/4" hole at least five (5) full turns.

NOTE: The Rapid Fire Pulser is not designed for use with 220V. Connecting to a 220V circuit will render the pulser inoperable and beyond repair.

6. Attach the black and white barrier wires to a "switched" 115 VAC circuit. The solenoid, pump motor or electric reset circuits are suitable options.

The circuit must be "hot" when the dispenser is in use and "dead" when the operating handle is turned off.

NOTE: This step must be performed properly. The pulser must be connected to a circuit which will turn off between sales to maintain accuracy and ensure reliable operation.

7. Attach the blue barrier wires to the "pulse circuit" from the console. (These wires are interchangeable.)
8. Confirm the switch position is in the correct position for the application. See list in #4 above.
9. Re-install the junction box cover.

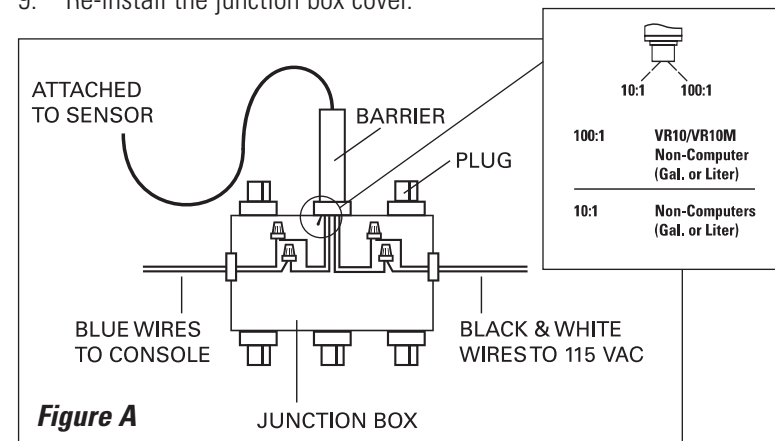

Figure A

Switchable Rapid-Fire Sensor Installation — Lower Wheel Bank (Refer to Figure B)

1. Remove all panels, face plates, etc., to completely expose the rear (non-totalizer side) of the non-computer.
2. Remove the two Torx T20 screws that fasten the tie bar located above the lower wheel bank of the non-computer. Remove the tie bar.
3. The sensor is pre-attached to a tie bar. The sensor has a modified bracket (#1 in Figure B) allow the sensor gear to engage with the lower wheel bank drive gear.

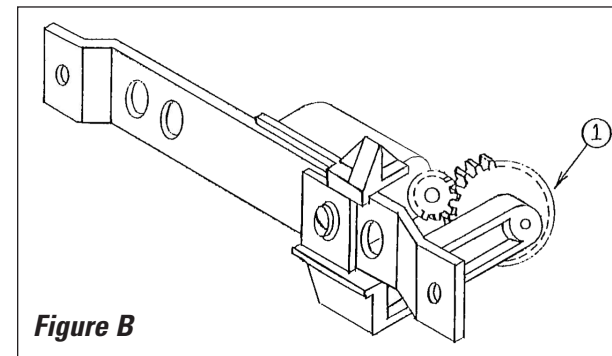
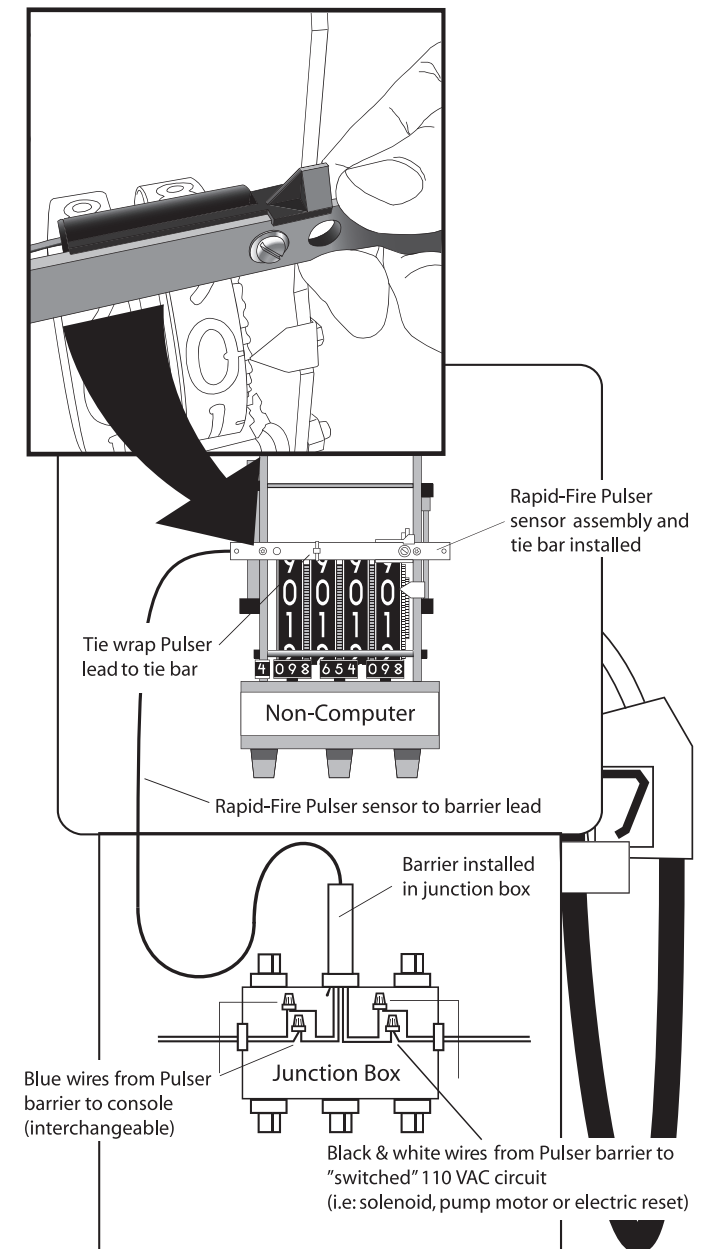
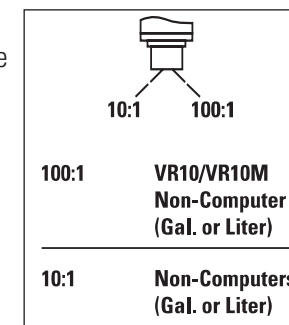

Figure B

4. The cable coming from the sensor has been tie wrapped to the tie bar.
5. Route the sensor cable out of the non-computer. Do not route it near other wires or over sharp metal edges.
6. Reattach the tie bar to the non-computer with two Torx T20 screws. Be sure that the sensor gear is properly engaged with the wheel drive gear.
7. Check to ensure that the sensor cable does not interfere with the non-computer wheels, reset mechanism or any other moving component.
8. Tie wrap the cable in at least one location.
9. Reinstall all panels, face plates, etc.
10. Apply power to the dispenser.
11. Test the system by pumping fuel into an approved container.
12. If you have any questions, call 1-800-243-6628.

Operation

PMP 48504 Switchable Rapid-Fire Pulser has a 2-position switch.



WARNING! TURN OFF ALL POWER TO DISPENSER BEFORE INSTALLING RAPID-FIRE PULSER